

# Suspended Ceiling Clip Guide

For use with ZipTwo | 707 and Wedge | 707

Technical Support: 707.996.9898 | [technicalsupport@vode.com](mailto:technicalsupport@vode.com)

Vode carries custom clip options to secure the ZipTwo to a wide variety of suspended ceiling T-Bar and panel combinations. All clips are painted white and designed to minimize the gap between the fixture and ceiling system.

Clips rotate to allow ZipTwo placement on T-Bar or perpendicular to T-Bar. If you do not see a clip option for your specific application, contact Vode or your Vode agent with your specific requirements.

## T-Bar Options

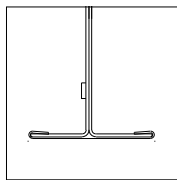

**Armstrong®:** Prelude® XL® 15/16"

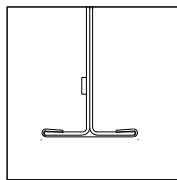

Suprafine® 9/16"

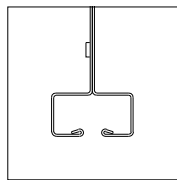

Silhouette® XL 1/8" Reveal

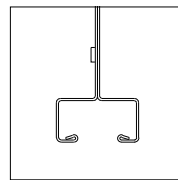

Silhouette® XL 1/4" Reveal

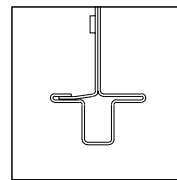

Interlude®

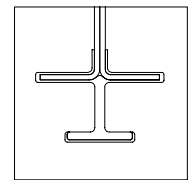

Sonata®

**USG Donn®:** DX® / DXL™  
CE™ / DXLA™  
ZXL™ / AX™  
DXSS™

Centricitee™

Finline® 1/8"

Finline® 1/4"

## Panel Options

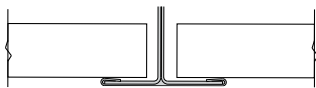

### Square Lay-In

Lay-in panels are one of the most inexpensive and widely used panel types. Clips are more exposed in these applications.

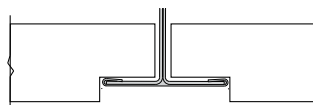

### Tegular

Tegular panels are extremely versatile and come in a wide variety of styles and depths. Clips are less exposed or may be completely hidden in these applications.

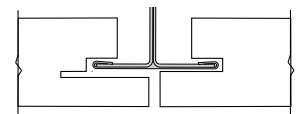

### Concealed

Concealed panels, like the Armstrong Vector(R), leave a thin reveal between panels. Clips are completely hidden in these applications.

## Clip Options

Clips are designed to minimize the gap between the fixture and ceiling panels, a small amount of panel material around clips should be shaved down to optimize fit for flat panels and tegular panels with depths of 1/16" - 1/8". If you do not see a clip option for your specific application, contact Vode or your Vode agent with your specific requirements.

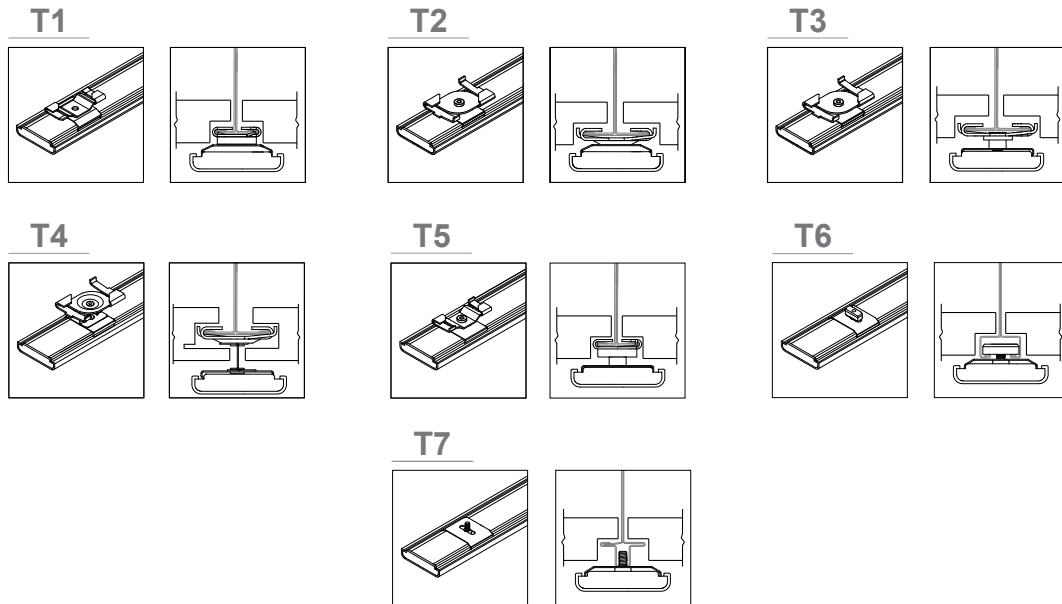

## Compatibility Chart for Armstrong®

	Flat	1/16"	1/8"	1/4"	15/16"	13/32"	Vector D	Vector H
Suprafine 9/16"	<b>T1</b>	<b>T1</b>	<b>T1</b>	<b>T5</b>	<b>T5</b>	Special Order	—	—
Prelude XL 15/16"	<b>T2</b>	<b>T2</b>	<b>T2</b>	<b>T3</b>	<b>T3</b>	Special Order	Special Order	<b>T4</b>
Silhouette XL 1/8" Reveal	—	—	—	—	<b>T6</b>	—	—	—
Silhouette XL 1/4" Reveal	—	—	—	—	<b>T6</b>	—	—	—
Interlude	—	—	—	—	<b>T7</b>	—	—	—
Sonata	—	—	—	—	Special Order	—	—	—

## Compatibility Chart for USG Donn®

	Flat	1/16"	1/8"	1/4"	15/16"	13/32"	Vector D	Vector H
Centrictee	<b>T1</b>	<b>T1</b>	<b>T1</b>	<b>T5</b>	<b>T5</b>	Special Order	—	—
15/16" T-Bar	<b>T2</b>	<b>T2</b>	<b>T2</b>	<b>T3</b>	<b>T3</b>	Special Order	Special Order	<b>T4</b>
Fineline 1/8"	—	—	—	—	<b>T6</b>	—	—	—
Fineline 1/4"	—	—	—	—	<b>T6</b>	—	—	—